

Managing iPad Videos in Schools

by @iPadWells

iPad4Schools.org



YOUTUBE 4 TEACHERS

All the teachers I work with directly use the same Youtube (Google) account to store and share videos. Students can then subscribe to the individual courses and teachers can colate videos together.

These videos might be:

1. Recorded by their iPads
2. Recorded by Student iPads
3. Explain Everything (App) whiteboard lessons
4. Video tutorials for practical tasks
5. Youtube videos discovered on Youtube itself and added to course "Playlists"

Here's an intro into how we use and manage our Youtube account.

Step 1: Sign up to Google as a department or school.

Step 2: Visit Youtube and login with Google account to activate the Youtube account.

Courses / Topics should be organised by "Playlist"

Video Manager

Department / School Account menu - (Click this little arrow)

Privacy Settings?
When uploading, all videos are set as "Unlisted" or "Private" (See Page 3)

Playlists (Courses / Topics)

APPS

Apps that can be permanently logged-in to the account



YouTube



iMovie



Camera



Explain Everything
(Recordable Whiteboard)



Photos



Google Plus

Playlisting a video

Whether you upload a video from one of the apps above or find a great video on Youtube, all can be grouped in a Playlist as a course or topic.

Student work?
Teachers can login with the same account on a student iPad, upload and logout. Great for managing student video output

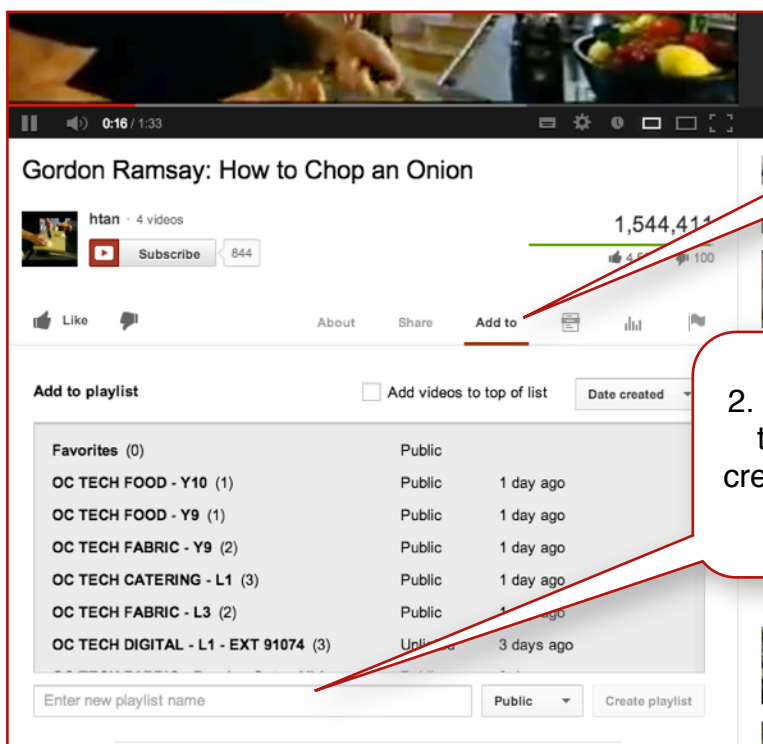

1. Under a video playing on youtube Click "Add to"

2. Either click a Playlist that you've already created or create a new Playlist here.

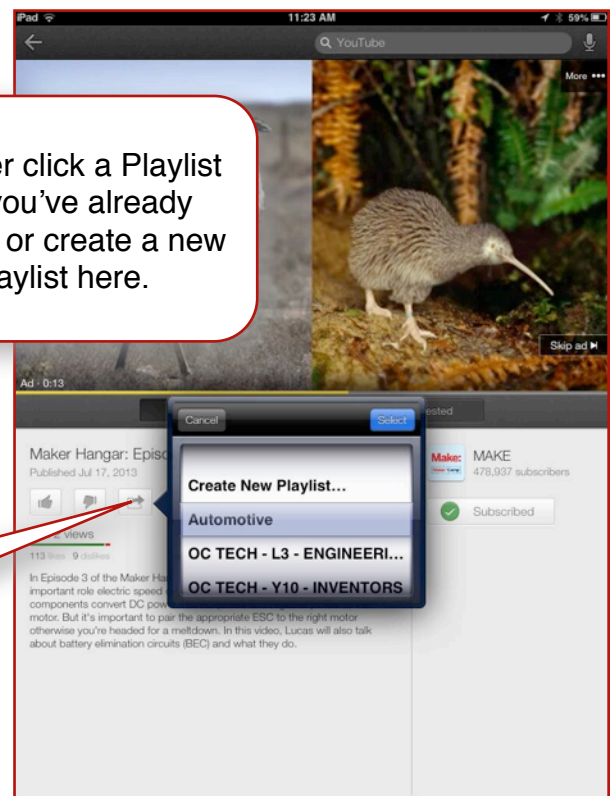

This can also be done on the iPad's YouTube App

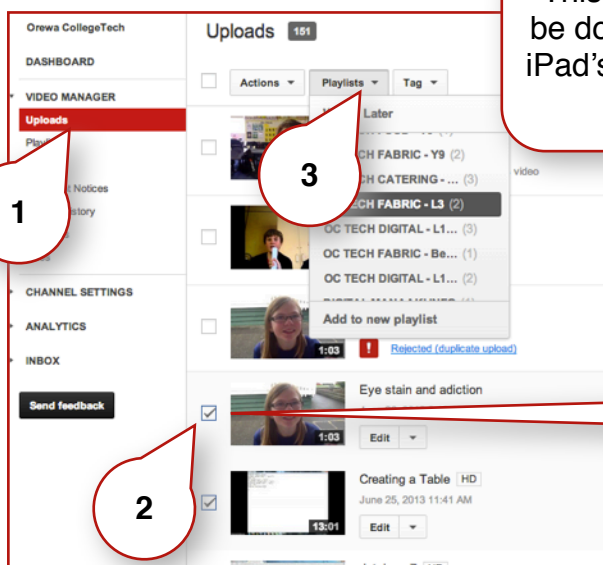

Using the Video Manager mentioned on Page 1, you can Playlist multiply videos recently uploaded by ticking them and choosing a playlist.

PRIVACY SETTINGS (PUBLIC vs PRIVATE vs UNLISTED?)

What's Unlisted?

To keep things simple I tell my staff to always use **Unlisted** unless the video involves a student's face. Unlisted means that the video is not discoverable when searching Youtube but you can use the video's web address in your school's LMS or on Worksheets to send students & parents directly to the video.

Setting on website

Setting on iPad App

Unlisted = Sharable but hidden

Initially uploads are limited to 15 minutes max & 1GB but this can be extended in the Youtube account settings with a mobile phone check. This can effect both the length and definition you choose.

Standard Definition (~16MB/s) ✓

HD (~460KB)

Tags

Category Comedy

Public ✓
Anyone can search for and view

Unlisted
Anyone with a link can view

Private
Only specific YouTube users can view

Enhancements
change colour settings and style (A bit like Instagram Photos)

Annotations
allow you to enhance the videos with extra info or instructions

Enhancements and Annotations
When you are on the website and viewing the settings for one of your uploads

Sharing
Under any **video** or entire **playlist**, the "Share" option gives you the web address you can give to students etc.

Embed gives you the HTML code to paste into your School's LMS or Website. All videos in a playlist will then play from within your website, LMS or Blog.

Like **About** **Share** **Add to**

Share this video **Embed** Email Video call

☒ Share with playlist starting from **current video**

```
<iframe width="560" height="315"
src="//www.youtube.com/embed/TwGBt3V0yvc?
list=PLjxSziLo50V_YMGD2jVgwoG06DG12LuVv" frameborder="0"
allowfullscreen></iframe>
```

Video size: 560 x 315